

AV-over-IP Multicast System MV-500T/MV-500R

Deliver your live message and digital signage contents



MV-500 system easily establishes AV-over-IP multicasting setup by utilizing available display devices. The live multicasting over MV-500 superiorly synchronizes among displays to avoid sound interference. Use MV-500R as a digital signage player when no live multicasting is available.

Features

- Live audio/video multicasting to up to 1,000 receiver over your network
- Proprietary LipSync technology to deliver clear sounds without interference from other receivers.
- Scheduling and preloading of your programs to each MV-500R to playback
- Portable MV-500T making a live setup easier at anywhere your LAN is available.
- Turning ON and OFF your displays through CEC
- Free silex Media Transporter® E model
- School classroom experience enhancement together with silex's interactive display adapter Wi-Fi access point.

Program Scheduling and Distribution

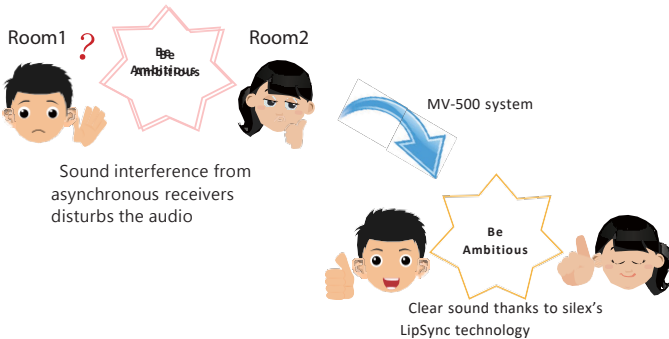
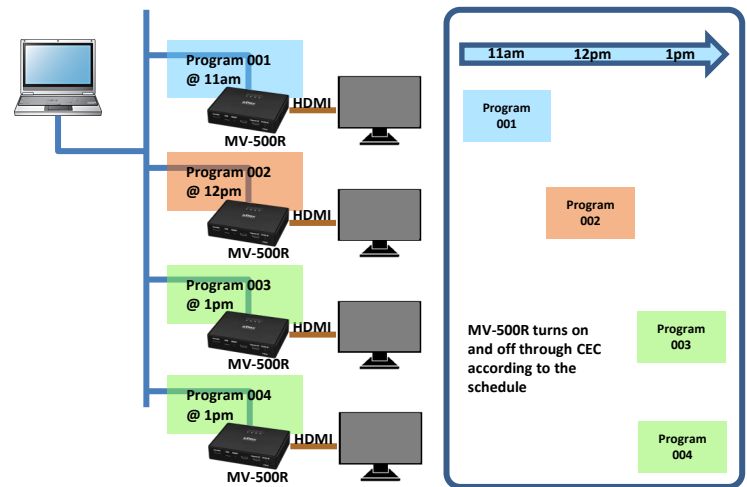

silex Media Transporter®



Live Multicasting

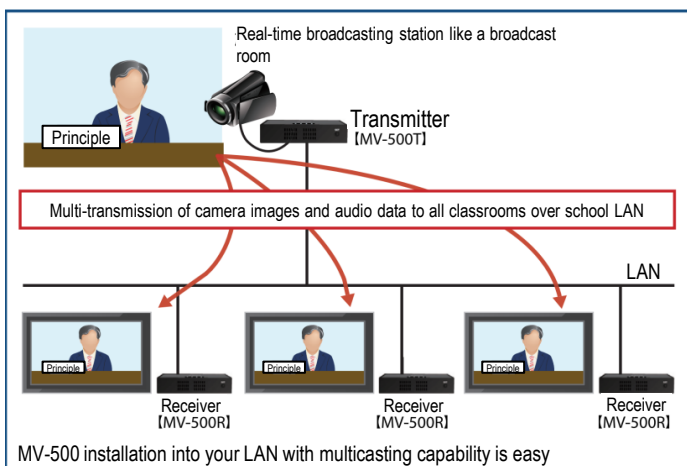

- Easy scheduling of your contents
- Display turning on and off through CEC
- Unique content scheduling per each receiver
- Program history log up to past three years
- Recurring scheduling of your contents

※ Displays must support CEC commands to turn on and off the displays through MV-500 system.

Pairing with Wi-Fi AP interactive display adapter

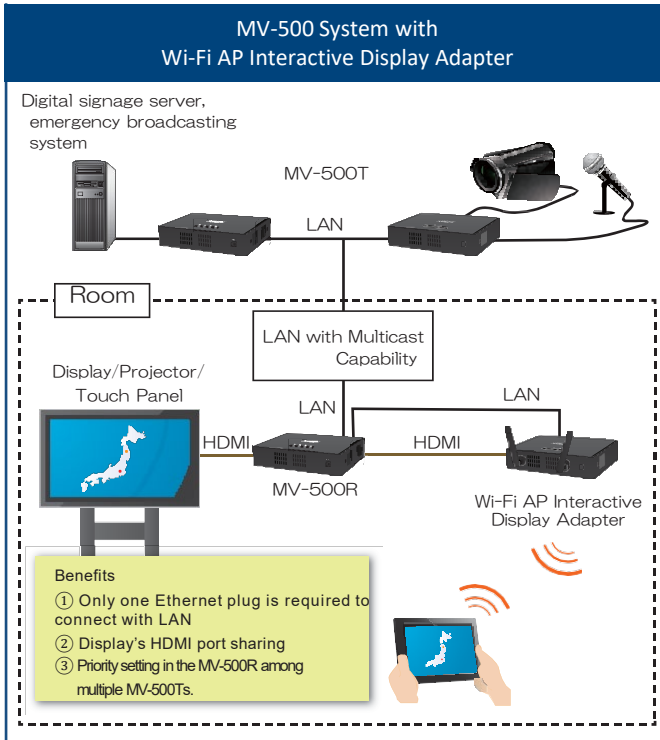
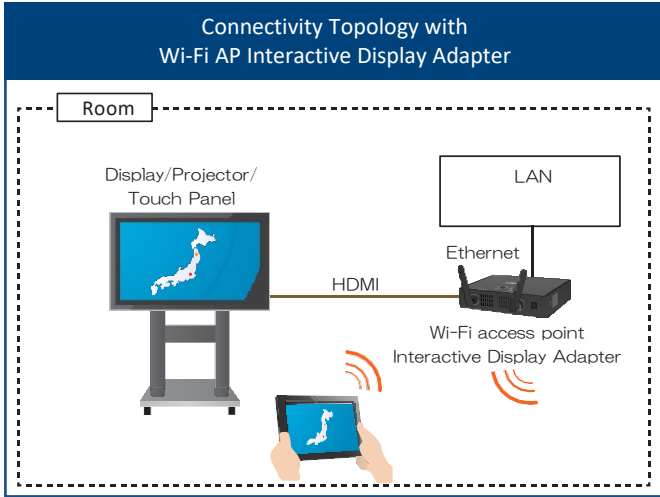

Option

Wall Mounting Kit (Bracket Type III)

A metal bracket to mount MV-500 on the wall/ceiling.



MV-500 Specifications

Product Name	AV-over-IP multicasting system	
	MV-500T	MV-500R
Video Interface	DVI (input)	HDMI (output)
Audio Interface	φ 3.5mm stereo mini (in)	HDMI (output)
Interface with interactive display adapter access point	-	LAN port x 1 HDMI port x 1
Maximum frame rate	30fps	
Video codec	JPEG-XR	
Wired LAN Interface	RJ-45 x 1 port (Auto MDI/MDI-X support) 100BASE-TX/1000BASE-T (Auto)	
microSD	-	microSDHC (max: 32GB)
Push switch	-	1 for initialization
System admin. SW	SX Smart Manager Pro for MV-500	
Contents Management SW	silex Media Transporter®	
Network Admin SW	AMC Manager®	
Power Supply	AC adapter 100-240V 50/60Hz DC 5V output	
Regulatory Compliance	VCCI Class A, FCC Class B, RoHS	
Max Power Consumption	10W	
Dimension	155mm x 120mm x 32mm	
Weight	255g	250g
Included Items	Body, AC adapter, CD-ROM (only MV-500T), warranty notice	

Display resolution	Aspect ratio	MV-500T (TX)		MV-500R (RX)
		Digital	Analog	Digital
VGA (640 x 480)	4:3	○	○	○
480p (720 x 480)	4:3/16:9	○	○	○
SVGA (800 x 600)	4:3	○	○	○
XGA (1024 x 768)	4:3	○	○	○
720p (1280 x 720)	16:9	○	X	○
WXGA (1280 x 768)	15:9	○	X	○
SXGA (1280 x 1024)	5:4	○	X	○
FWXGA (1360 x 768)	16:9	○	X	○
WSXGA (1600 x 1024)	25:16	○	X	○
Full HD (1920 x 1080)	16:9	○	X	○

Product Name	silex Media Transporter®	
Supported OS	Windows 7 SP1(32bit/64bit) Windows 8 (32bit/64bit) Windows 8.1 (32bit/64bit) Windows 10 (32bit/64bit) Windows 10 Anniversary Update	
Supported File Format	Video: WMV, AVI, MPEG4, H.264 Image: BMP, PNG, JPEG Multi-core CPU at over 2GHz More than 2GB RAM	
Recommended requirement	system	1280 x 768 or larger screen resolution More than 10GB free disk space *.NetFramework 4.5.2 or later is required.

Silex technology is a registered trademark of silex technology, Inc. other product or brand names may be registered trademarks or trademarks of their respective owners. Technical information and specifications are subject to change without notice. © 2021 silex technology, Inc. All rights reserved.



silex global sales & support locations



US Office
silex technology america, Inc.
US toll free 657-218-5199
www.silextechnology.com
sales@silexamerica.com

Europe Office
silex technology europe, GmbH
+49-2154-88967-0
Germany toll free 0800-7453938
www.silextechnology.com
sales@silexeurope.com

India Office
silex technology india, Pvt. Ltd.
+91-44-43033234
www.silex-india.com
support@silex-india.com

Corporate Headquarters silex technology, Inc.
+81-774-98-3781
www.silex.jp
support@silex.jp